



3-WAY SCREWED END BALL VALVE



FEATURES

- **L port / T port**, 1/4"~2" (DN8~DN50)
 - W.P. : 1000 WOG (PN63)
 - W.T. : -20°C~200°C (-4°F~392°F)
 - Investment casting
 - Blow-out proof stem
 - Locking device
 - Anti-static device (option)
 - ISO 5211 Direct mounting pad
 - **Automation accessories (option)**
- Thread type : ASME B1.20.1 (NPT)
DIN2999 & BS21
ISO7/1 & EN10226

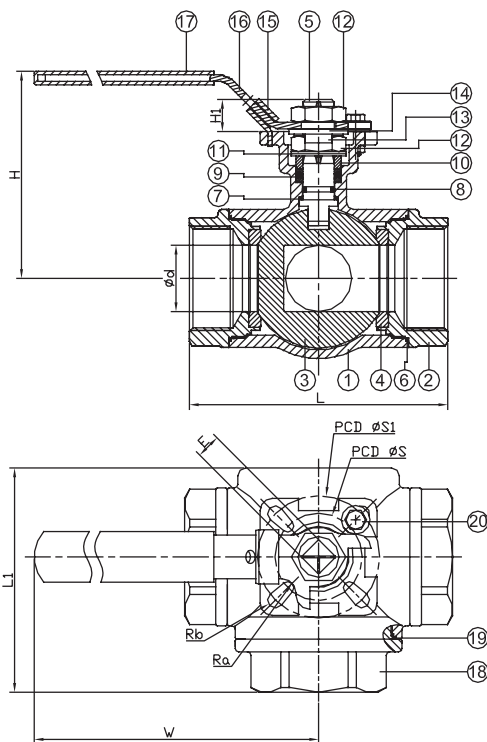

ITEM	PARTS	MATERIAL
1	BODY	ASTM A351-CF8M
2	CAP-A	
3	BALL	
4	SEAT	PTFE
5	STEM	AISI 316
6	SEAL-A	PTFE
7	THRUST WASHER	PEEK+PTFE
8	O-RING	VITON
9	PACKING	PTFE
10	GLAND	AISI 304
11	BELLEVILLE WASHER	
12	STEM NUT	
13	LOCKING WASHER	
14	HANDLE WASHER	
15	LOCKING DEVICE	
16	HANDLE	PVC
17	HANDLE SLEEVE	
18	CAP-B	ASTM A351-CF8M
19	SEAL-B	PTFE
20	STOP PIN	AISI 304

DN	d	L	L1	H	W	S	S1	H1	E	Ra	Rb	Torque (N-M)
8	11.6	76	58.5	73	123	36	42	9	9	3	3	10
10	12.5	76	58.5	73	123	36	42	9	9	3	3	10
15	12.5	76	58.5	73	123	36	42	9	9	3	3	10
20	16	86	72	76	123	36	42	9	9	3	3	15
25	20	99	81.5	87	153	42	50	11	11	3	3.5	22
32	25	117	94.5	93	153	42	50	11	11	3	3.5	30
40	32	124	104	110	183	50	70	14	14	3.5	4.5	47
50	38	148	125	119	183	50	70	14	14	3.5	4.5	58

unit:mm

NPS	d	L	L1	H	W	S	S1	H1	E	Ra	Rb	Torque (in-lb)
1/4"	0.46	2.99	2.3	2.87	4.84	1.42	1.65	0.35	0.35	0.12	0.12	88.5
3/8"	0.49	2.99	2.3	2.87	4.84	1.42	1.65	0.35	0.35	0.12	0.12	88.5
1/2"	0.49	2.99	2.3	2.87	4.84	1.42	1.65	0.35	0.35	0.12	0.12	88.5
3/4"	0.63	3.39	2.83	2.99	4.84	1.42	1.65	0.35	0.35	0.12	0.12	132.8
1"	0.79	3.9	3.21	3.43	6.02	1.65	1.97	0.43	0.43	0.12	0.14	194.7
1-1/4"	0.98	4.61	3.72	3.66	6.02	1.65	1.97	0.43	0.43	0.12	0.14	265.5
1-1/2"	1.26	4.88	4.09	4.33	7.2	1.97	2.76	0.55	0.55	0.14	0.18	416
2"	1.5	5.83	4.92	4.69	7.2	1.97	2.76	0.55	0.55	0.14	0.18	513.3

unit:in

Add:Shacheng Industrial Park ,Longwan District,Wenzhou City 325025,
ZheJiang Province,China

Tel/Fax: +86-577-8986-3679 Mobile : +86 189 5773 1879

<http://www.cncxvalve.com>

Email:sales@cncxvalve.com